

Samsung Compact Combination Steamer CS40

[> Web link](#)

Model
Samsung Compact Combination Steamer CS40

Energy efficiency class
A+

Manufacturer ID
NQ50C7935ES/EF

Article no.
500.000.007.00

Appliance type
Compact unit

Construction
Euro Norm 60 cm

VRG
10.00

Price CHF
695.- excl. VAT

Highlights

- 35 automatic programs
- 50 L cooking capacity - exceptionally spacious
- Steam cleaning aid
- 0.75 L water tank for steamer function
- Dual fan with double hot air: to cook fast, efficient and consistent
- Compact: combined steamer and oven
- Cooking chamber with ceramic enamel: scratch-proof, anti-bacterial
- Easy to operate: retractable knob and sensor buttons

Product description

Construction: **Euro-Norm 60 cm**
GTIN-Nr.: **8806085188785**

Efficiency and consumption

Energy efficiency class (from A+++ to D): **A+**

Energy efficiency index: **77.63**

Energy consumption

Energy consumption, conventional (kWh / cycle): -

Energy consumption, convection / hot air (kWh / cycle): **0,59 kWh**

Standby consumption: **0,5 W**

Consumption pyrolytic cleaning process (kWh / cycle): -

Design

Color control panel: **Silver**

Material control panel: **Stainless Steel**

Frame / material: **Yes / stainless steel**

Display and operation

Display: **Digital display**

Display and lighting: **LED, ice blue**

Operation: **Retractable knob, sensor buttons**

Interconnection of household appliances

Samsung Smart Home: -

Performance properties

max. adjustable temperature for top / bottom heat, convection / hot air: **250°C**

Temperature for steam operation: **100°C**

Microwave power output -

Useable grilling space: **2970 cm2**

Useable oven capacity: **50 L**

Dimensions

Height: **45.4 cm**

Width: **59.5 cm**

Depth: **54.9 cm**

Depth (from front of unit): **56.5 cm**

Depth with open door (in front of unit): -

Unit dimensions (H x W x D): **454 x 595 x 549 mm**

Empty weight

Unit weight: **39 kg**

Fittings

Inside dimensions (useable size) mm (height / width / depth): **247 x 443 x 443 mm**

Top and bottom heat: **Yes**

Convection:

Samsung Compact Combination Steamer CS40[> Web link](#)**Yes**Hot air: **Yes**Steam: **Yes**

Microwave: -

Catalytic cleaning aid : **Yes**

Pyrolytic cleaning aid : -

Grill heating element available / retrofittable: **Yes / -**Grill motor / convection grilling: - / **Yes**Timer switch / timer: **Yes**Drawer / warming drawer: - / **optional**Number of cooking chambers: **1**

Volume per cooking chamber

Single-chamber operation / top cooking chamber / bottom cooking chamber: **50 L / - / -**Number of shelf levels: **4**Lighting / inspection window: **Yes / Yes**Lighting : **2 x 25W, halogen**

Telescope rails: -

Cleaning: **Catalysis, steam cleaning**Cooling process: **Cooling ventilator**Interior lining: **Ceramic enamel****Operating modes**Steam: **40~100°C**Steam + heating: **Yes**Steam + hot air: **Yes**

Steam + top heat + hot air: -

Steam + bottom heat + hot air: -

Top / bottom heat: **Yes**Hot air: **40~250°C**Hot air ECO: **40~250°C**Grill: large / eco / convection: - / - / **150~250°C**Bottom heat + hot air: **40~250°C**Top heat + hot air: **40~250°C**

Bottom heat : -

Fast cooking: **40~250°C**Automatic roasting (ProRoasting) : **40~150°C**

Microwave + grill: -

Microwave + hot air: -

ProgramsSpecial functions: **Pre-warming, time, end time, cooking time, time delay**Automatic programs: **35**

Dual Cook: -

Control functionsControl functions: **Time, child safety, kitchen timer, oven temperature, end time, signal tone, defrosting****Capacity**Total capacity: **3200 W**Hot air : **1000 W**Top heat : **1400 / 1100 W**Bottom heat : **1100 W**Grill max. / min.: **2500 W**

Large-sized grill: -

Steam: **1700 W**

Microwave: -

Electrical connectionSupply voltage g: **230 V**Frequency : **50 Hz**Connection values: **3.2 kWh**Fuse protection: **16 A**Length power connection: **1.2 m**Power plug: **Plug type 23, 16 A****Technical data**Standard width: **Euro-Norm 60 cm**Standard height: **Euro-Norm 45 cm**Niche height: **446 mm - 450 mm**Niche width: **564 mm - 568 mm**Niche depth: **min. 550 mm**Niche dimensions (H x W x D): **min. 446-450 x 564-568 x 550 mm**Unit width in mm : **595 mm**Unit height in mm: **494 mm**Unit depth in mm: **549 mm****Packaging**Weight, incl. packaging: **41.5 kg**

Packaging dimensions (H x W x D):

Samsung Compact Combination Steamer CS40 > Web link

584 x 697 x 647 mm

Smart combination tip:

This appliance can be perfectly paired with a complementary unit (ref. 500.000.010.00 - Samsung warming drawer WS40) - for even greater comfort and functionality in your kitchen! Especially practical: both appliances fit together into a cabinet with a 600 mm niche height. Take advantage of this installation benefit and enjoy the added versatility it brings!

Accessory

Included accessories

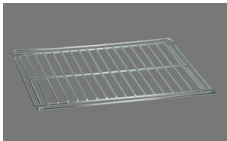

> Weblink
500.000.044.00 / CHF
695.-
Oven grill



> Weblink
500.000.047.00 / CHF
695.-
Cooking container, with
holes

Optional accessories



> Weblink
500.000.074.00 / CHF
60.-
Set of support brackets

Compatible Articles



> Weblink
500.000.007.00 / CHF
695.-
Compact Combination
Steamer CS40

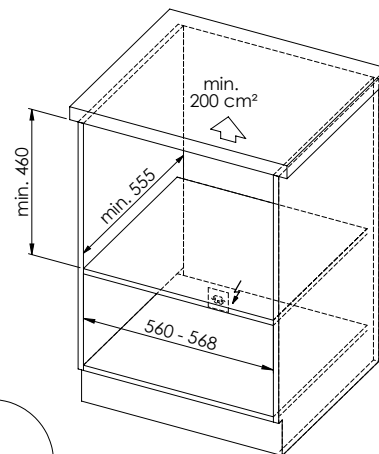
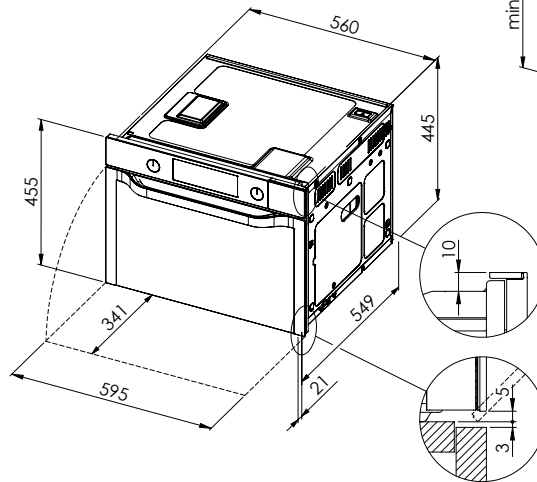
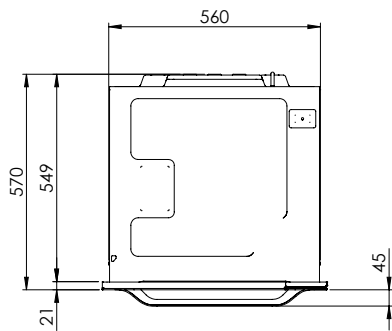
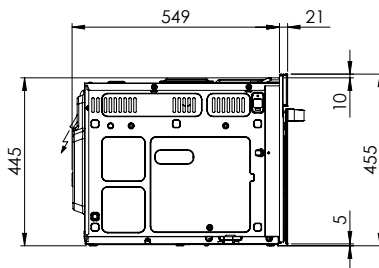
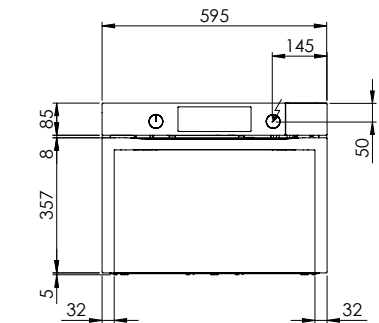

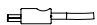
 CS40: 230 V / 16 A, T23, 1200 mm

Für diese Zeichnung sind alle Rechte vorbehalten. Nachdruck, Vervielfältigung und Verbreitung, auch auszugsweise, ist ohne schriftliche Genehmigung der Suter Inox AG. All rights reserved.
 Toute réimpression ou utilisation non autorisée sans la permission écrite de la Suter Inox AG est formellement interdite. Toute réimpression ou utilisation non autorisée sans la permission écrite de la Suter Inox AG est formellement interdite.

Samsung CS40 + WS40

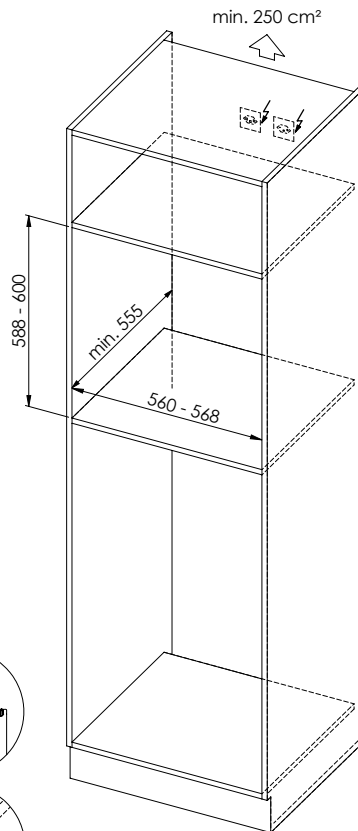
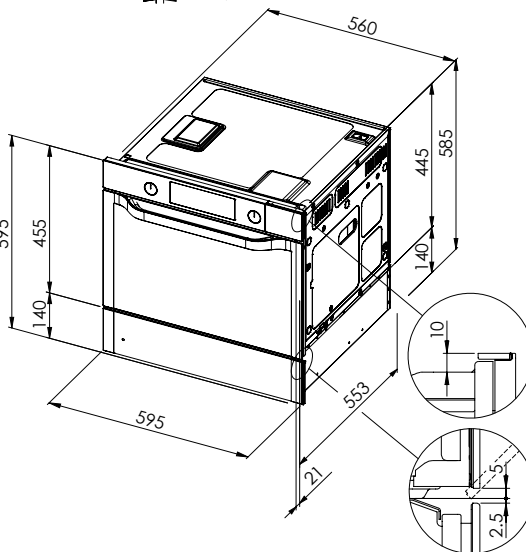
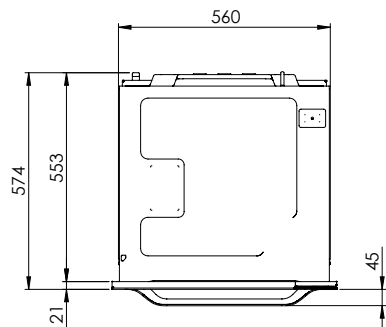
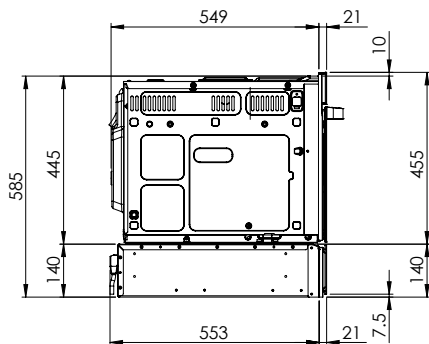
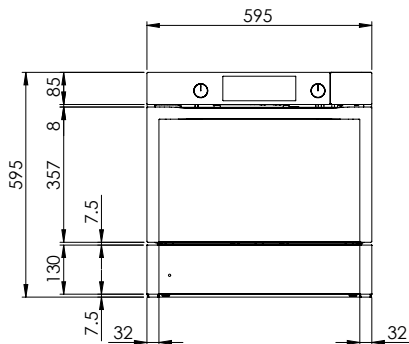

CS40: 230 V / 16 A, T23, 1200 mm
 WS40: 230 V / 10 A, T12, 1500 mm

Samsung CS40 + WS40

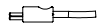
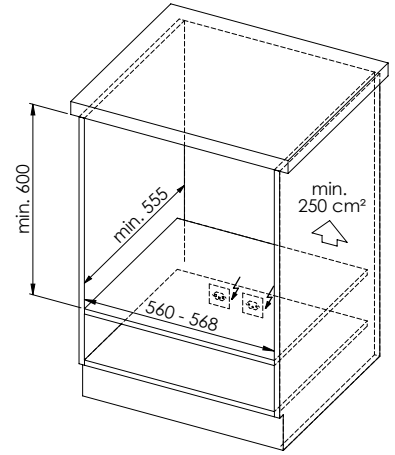
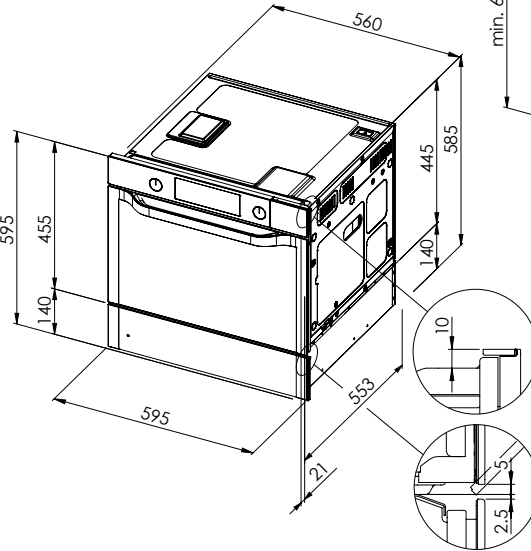
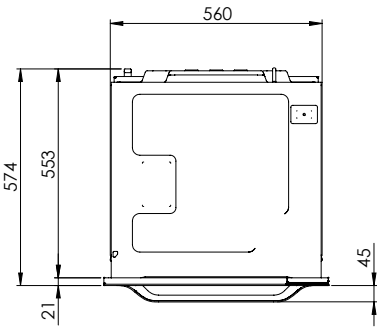
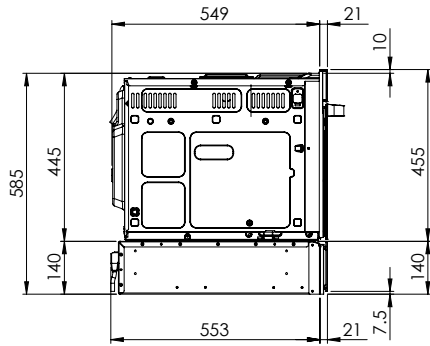
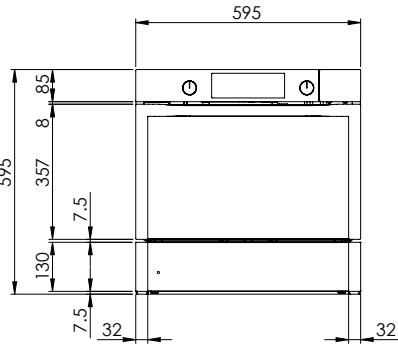

CS40: 230 V / 16 A, T23, 1200 mm
 WS40: 230 V / 10 A, T12, 1500 mm

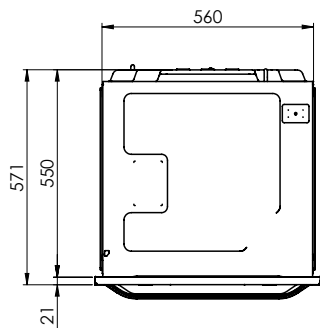
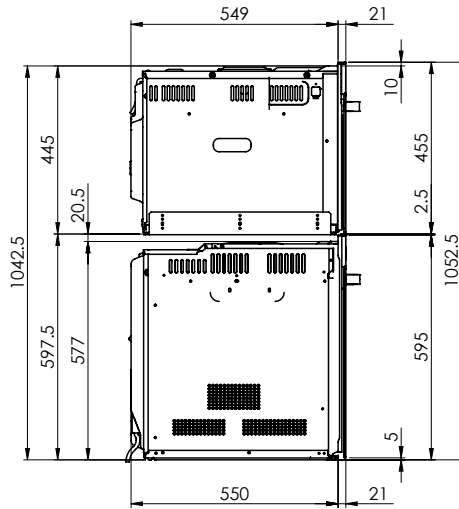
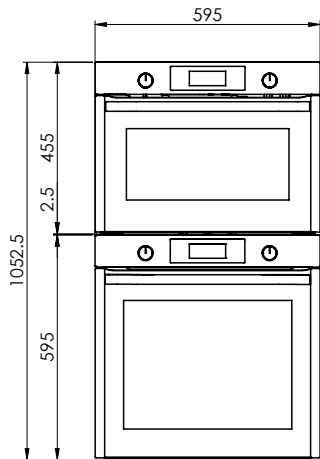

Bei Mehrgerätemontage übereinander: Berücksichtigen Sie bei der Planung der Elektroanschlüsse die jeweiligen Gerätespezifikationen.
 Montage de plusieurs appareils l'un sur l'autre: veuillez tenir compte des spécifications de chaque appareil lors de la planification des raccordements électriques.
 Montaggio in colonna di più apparecchi: nella pianificazione degli allacciamenti elettrici, attenersi alle specifiche dei rispettivi apparecchi.

Es ist das Nachwendrecht vorbehalten, dieses Diagramm, Gegenstandsbildungen, Zeichnungen, Verzeichnisse, Tabellen, Listen, Kataloge, Prospekte, Werbungen, Anzeigen, etc., ohne unsere Zustimmung zu veröffentlichen. © Copyright 2003 Suter Inox AG. All rights reserved.
 Toute réimpression ou utilisation non autorisée sans la permission écrite de la Suter Inox AG est formellement interdite.
 È vietata espressamente la ristampa o l'uso non autorizzato senza la nostra approvazione. © Copyright 2003 Suter Inox AG. Tutti i diritti sono riservati.

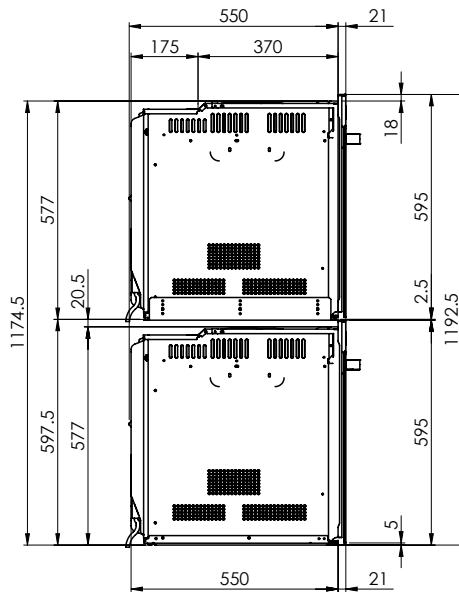
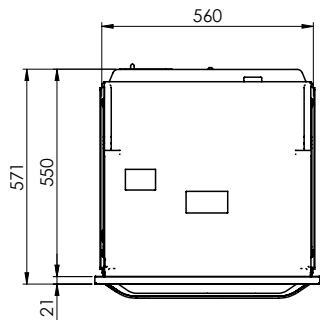
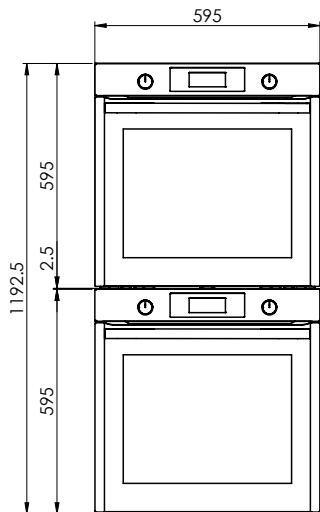

Bei Mehrgerätemontage übereinander: Berücksichtigen Sie bei der Planung der Elektroanschlüsse die jeweiligen Gerätespezifikationen.
 Montage de plusieurs appareils l'un sur l'autre: veuillez tenir compte des spécifications de chaque appareil lors de la planification des raccordements électriques.
 Montaggio in colonna di più apparecchi: nella pianificazione degli allacciamenti elettrici, attenersi alle specifiche dei rispettivi apparecchi.

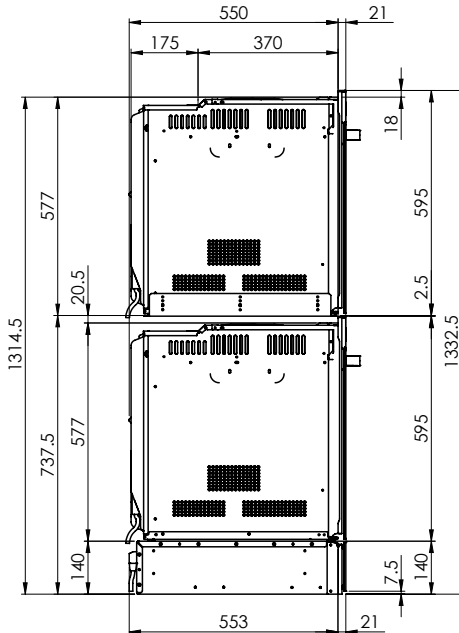
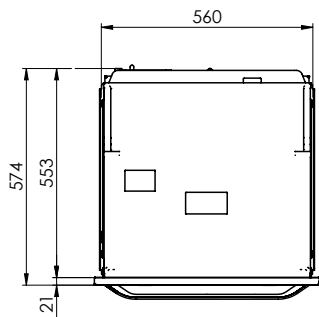
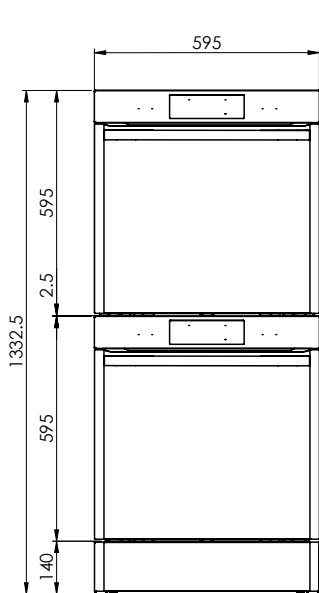

Bei Mehrgerätemontage übereinander: Berücksichtigen Sie bei der Planung der Elektroanschlüsse die jeweiligen Gerätespezifikationen.
 Montage de plusieurs appareils l'un sur l'autre: veuillez tenir compte des spécifications de chaque appareil lors de la planification des raccordements électriques.
 Montaggio in colonna di più apparecchi: nella pianificazione degli allacciamenti elettrici, attenersi alle specifiche dei rispettivi apparecchi.

