

Samsung Drawer WS10/20/30/50

[> Web link](#)

Article no.
500.000.009.00

VRG
7.51
Price CHF
350.- excl. VAT

Product description

Construction: **Euro-Norm 60 cm**
GTIN-Nr.: **8806086700887**

Consumption

Energy consumption

Keeping warm: **420 W**
Energy consumption: **420 W**

Design

Color: **Black**
Material: **Glass**
Frame / material: **Yes (width: 25 mm) / stainless steel**

Display and operation

Display and lighting: **LED status indicator, orange**
Operation: **Knob (mechanical)**

Performance properties

Adjustable temperature: **30°C - 80°C**
Increase: **5°C**
Interior capacity: **25,2 L**

Dimensions

Height: **14 cm**
Width: **59,5 cm**
Depth (from front of unit): **54.5 cm**
Opening size: **60 x 15 cm**
Unit dimensions (H x W x D): **140 x 595 x 545 mm**

Empty weight

Unit weight: **16,3 kg**

Fittings

Inside dimensions (height / width / depth): **100 x 500 x 470 mm**
Interior: **Stainless steel**
Bottom: **Non-slip mat**
Drawer: **Telescope rails**
Capacity: **25,2 L**
Number of shelf levels: **1**
Lighting / inspection window: **- / -**
Telescope rails: **Yes**
Load-bearing capacity: **up to 25 kg**

Functions

Defrosting: **30°C**
Letting dough rise: **40°C bis 50°C**
Pre-warming cups: **40°C bis 50°C**
Pre-warming plates: **60°C bis 70°C**
Keeping food warm: **80°C**

Loading

Espresso cups: **max. 80 pcs**
Plates (28 cm): **max. 20 pcs**

Electrical connection

Supply voltage: **230 V**
Frequency: **50 Hz**
Connection value: **0.42 kWh**
Fuse protection:

Samsung Drawer WS10/20/30/50

[> Web link](#)**10 A**Length power connection: **1.5 m**Power plug: **Schuko safety plug with CH adapter (10 A, type 12)****Technische Daten**Standard width: **Euro-Norm 60 cm**

Standard height: -

Niche height: **142 - 600 mm**Niche width: **560 - max. 568 mm**Niche depth: **min. 550 mm**Niche dimensions (H x W x D): **140-595 x 560-568 x min. 550 mm**Unit width in mm: **595 mm**Unit height in mm: **140 mm**Unit depth in mm: **545 mm****Packaging**Weight, incl. packaging: **18.3 kg**Packaging dimensions (H x W x D): **250 x 670 x 650 mm****Accessory**

Optional accessories

[> Weblink](#)

500.000.074.00 / CHF

60.-

Set of support brackets

Compatible Articles[> Weblink](#)

500.000.001.00 / CHF

880.-

BO20 Dual Door Oven
(Dual Cook Flex)[> Weblink](#)

500.000.002.00 / CHF

770.-

BO30 Dual Door Oven
(Dual Cook Flex)[> Weblink](#)

500.000.006.00 / CHF

520.-

Samsung Compact Oven
with Microwave BM30/50

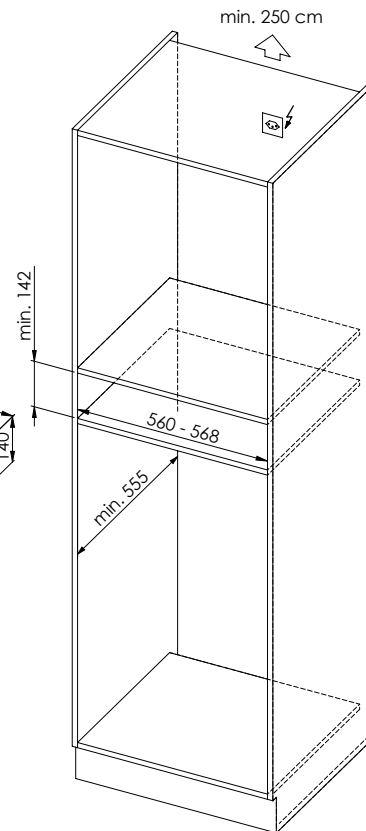
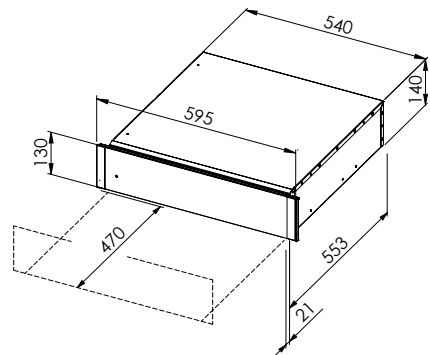
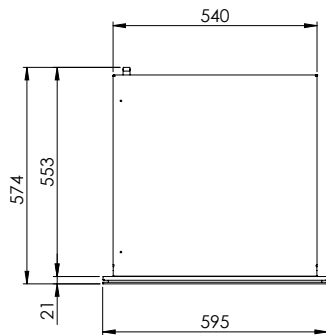
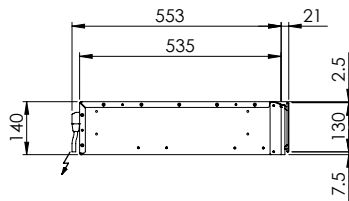
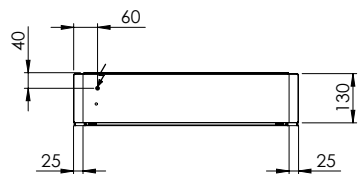

WS10/20/30/50: 230 V / 10 A, T12, 1500 mm

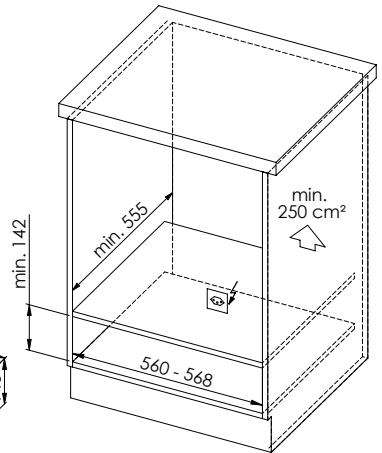
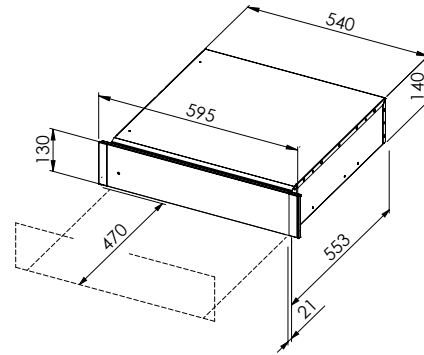
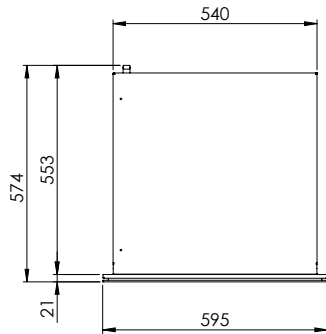
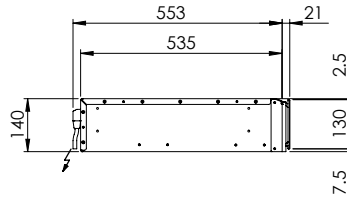
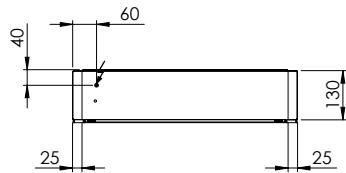

WS10/20/30/50: 230 V / 10 A, T12, 1500 mm

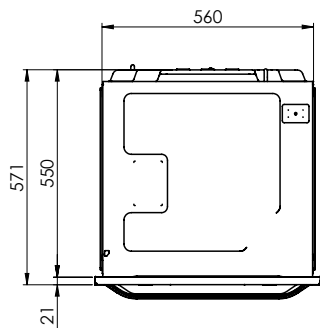
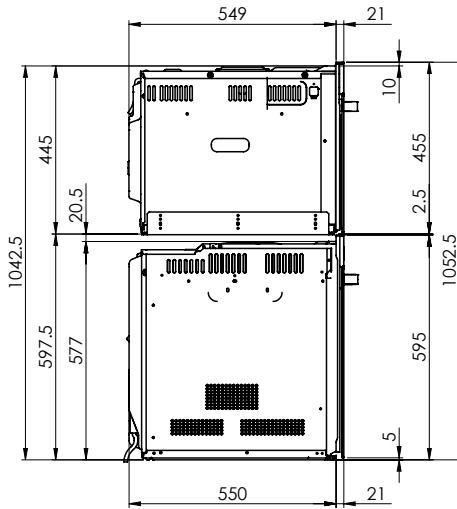
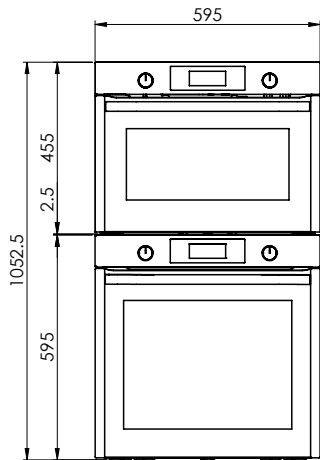

Bei Mehrgerätemontage übereinander: Berücksichtigen Sie bei der Planung der Elektroanschlüsse die jeweiligen Gerätespezifikationen.
 Montage de plusieurs appareils l'un sur l'autre: veuillez tenir compte des spécifications de chaque appareil lors de la planification des raccordements électriques.
 Montaggio in colonna di più apparecchi: nella pianificazione degli allacciamenti elettrici, attenersi alle specifiche dei rispettivi apparecchi.

Es ist das Nachwendrecht vorbehalten, dieses oder jenes Produkt, seine Beschreibung, Markenbezeichnung oder andere Angaben in irgendeiner Weise nachzuahmeln, ohne unsere Zustimmung zu erbitteln. © Copyright 2003 Suter Inox AG. All rights reserved.

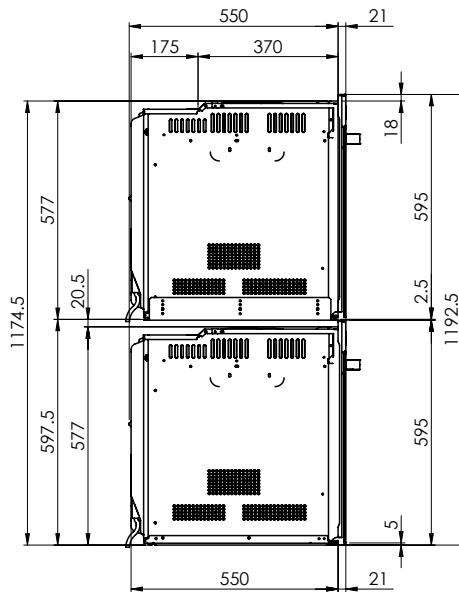
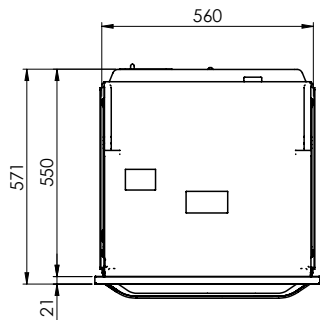
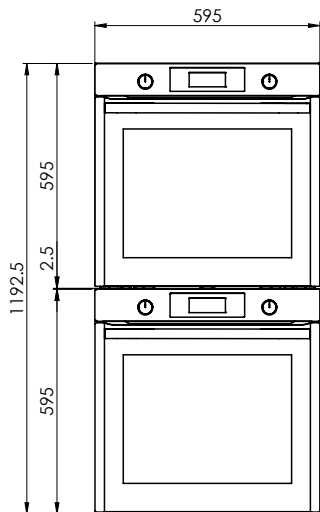

Bei Mehrgerätemontage übereinander: Berücksichtigen Sie bei der Planung der Elektroanschlüsse die jeweiligen Gerätespezifikationen.
 Montage de plusieurs appareils l'un sur l'autre: veuillez tenir compte des spécifications de chaque appareil lors de la planification des raccordements électriques.
 Montaggio in colonna di più apparecchi: nella pianificazione degli allacciamenti elettrici, attenersi alle specifiche dei rispettivi apparecchi.

