

## Linero LIO CDAB 50F/17 Black Edition

[> Web link](#)



Cabinet size 55 cm

**Fitting style**  
Flushmount sinks

**Model**  
LIO CDAB 50F/17 Black Edition

**Material**  
Cristadur

**Article no.**  
10.106.252.50

**Cabinet size**  
55 cm

**Basket**  
3½" Space-saving

**Color**  
Puro

**Price CHF**  
1'522.- excl. VAT

**Dimensions**  
500x400x165mm

**Corner radius**  
15 mm

### Overflow and drain technology



Sieve - type M, Black Edition



Swivelling overflow cap - Black Edition

**Basket pre-assembly**  
Basket pre-assembly ex works

**Dispenser - mounting option**  
Free choice of positioning

**Overflow and drain technology**  
**Standard push knob**



Push knob, powder-coated black, matt

### Prices (as of 06.05.26/excl. VAT)

Model	Material	Basket	Article no.	Price CHF	
Linero LIO CDAB 50F/17 Black E...	Cristadur, Puro	3½" Tipo	10.105.679.50	1'436.-	<a href="#">&gt; Weblink</a>
		3½" Space-saving	10.105.678.50	1'477.-	<a href="#">&gt; Weblink</a>
		3½" Space-saving	10.106.252.50	1'522.-	<a href="#">&gt; Weblink</a>
		3½" TouchFlow	10.105.677.50	1'675.-	<a href="#">&gt; Weblink</a>

### Accessory

#### Optional accessories



[> Weblink](#)  
40.000.912.00 / CHF 106.-  
Colander, perforated



[> Weblink](#)  
40.001.289.00 / CHF 106.-  
Colander, unperforated



[> Weblink](#)  
40.000.909.00 / CHF 151.-  
Chopping board, made of glass, white



[> Weblink](#)  
40.001.277.00 / CHF 151.-  
Chopping board, made of plastic

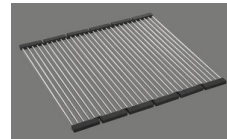

[> Weblink](#)  
40.001.138.00 / CHF 125.-  
Inox Pad



[> Weblink](#)  
40.001.509.00 / CHF 29.-  
Easy Care cleaning kit for granite sinks

### Spares

You can find the compatible range of spares here [> Weblink](#)

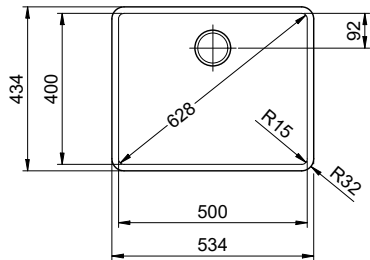

Für 12mm Arbeitsplatte.  
 Pour plan de travail de 12mm.  
 Per piano di lavoro da 12mm.

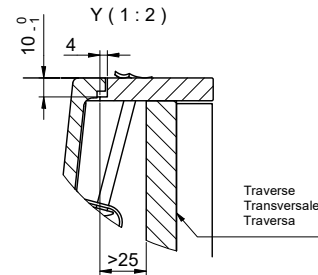
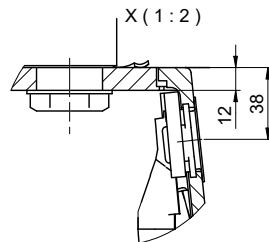

Für 13 - 30mm Arbeitsplatte.  
 Pour plan de travail de 13 - 30mm.  
 Per piano di lavoro da 13 - 30mm.

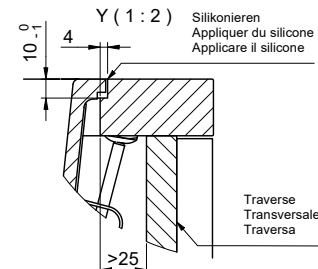
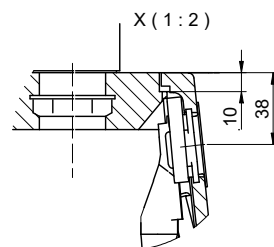

Für 13 - 50mm Arbeitsplatte.  
 Pour plan de travail de 13 - 50mm.  
 Per piano di lavoro da 13 - 50mm.

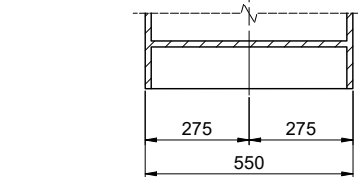
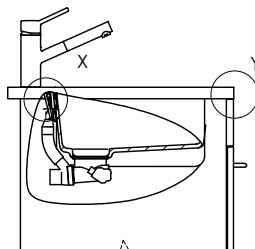
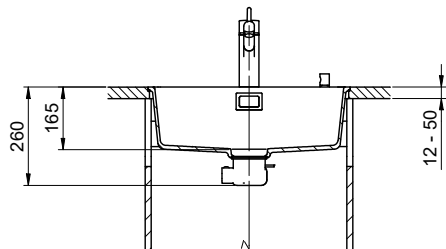
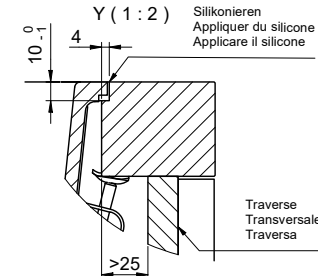
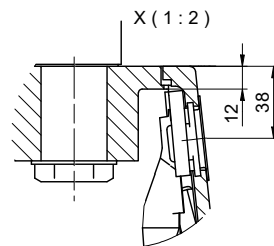

Bei der Planung die Traverse im Möbel beachten!

Faites attention à la barre transversale dans les meubles lors de la planification!

Presta attenzione alla traversa nei mobili durante la pianificazione!

Vom flächenbündigen Einbau in beschichtete Spanplatten raten wir ab.

Nous vous déconseillons le montage à fleur sur des panneaux de particules enduits.

Sconsigliamo il montaggio a filo top in pannelli di truciolato laminato.

# Linero LIO CD 50F/ 17 Desino

**Ausschnitt für flächenbündigen Einbau - Randbreite 17mm:**  
**Mesure de coupure pour montage à fleur - Bord de 17mm de largeur:**  
**Intaglio per montaggio a filo top - Larghezza bordo 17mm:**

Bohrung für Zug- und Druckknöpfe Ø14  
 Bohrung für Drehknopf Ø25

Trou pour boutons et Poussoirs de commande Ø14  
 Trou pour bouton rotatif Ø25

Foro per Pomelli tiranti e Pomelli pulsanti Ø14  
 Foro per Pomolo girevoli Ø25



min. 60mm bei stehender Traverse.  
 min. 80mm bei liegender Traverse.

min. 60mm avec traverse debout.  
 min. 80mm avec traverse allongé.

min. 60mm con traversa stante.  
 min. 80mm con traversa coricata.

Für 12mm Arbeitsplatte.  
 Pour plan de travail de 12mm.  
 Per piano di lavoro da 12mm



A-A (1 : 2)



Für 13 - 30mm Arbeitsplatte.  
 Pour plan de travail de 13 - 30mm.  
 Per piano di lavoro da 13 - 30mm.



A-A (1 : 2)



Für 13 - 50mm Arbeitsplatte.  
 Pour plan de travail de 13 - 50mm.  
 Per piano di lavoro da 13 - 50mm.



A-A (1 : 2)

