

Silver Star SIS 50U

[> Web link](#)



Cabinet size 55 cm

Fitting style
Undermount bowls

Model
SIS 50U

Material
Stainless steel 18/10

Article no.
10.102.981.00

Cabinet size
55 cm

Basket
3½" Tipó

Surface
Matt

Price CHF
913.- excl. VAT

Dimensions
500x420x175mm

Corner radius
50 mm

Overflow and drain technology



Sieve - type S



Concealed overflow

Basket pre-assembly

Assembly of the valve at the factory

Dispenser - mounting option

Free choice of positioning

Overflow and drain technology

Standard pull-up knob

Prices (as of 20.06.26/excl. VAT)

Model	Material	Basket	Article no.	Price CHF
Silver Star SIS 50U	Stainless steel 18/10, Matt	3½" Tipó	10.102.981.00	913.- > Weblink
	Stainless steel 18/10, Polished	3½" Tipó	10.102.982.00	913.- > Weblink
	Stainless steel 18/10, Matt	3½" Space-saving	10.102.670.00	954.- > Weblink
	Stainless steel 18/10, Polished	3½" Space-saving	10.102.812.00	954.- > Weblink

Accessory

Optional accessories



> Weblink
40.000.914.00 / CHF
106.-
Colander, perforated



> Weblink
40.001.290.00 / CHF
106.-
Colander, unperforated

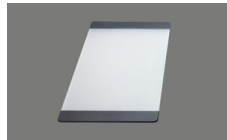

> Weblink
40.000.915.00 / CHF
151.-
Chopping board, made of
glass, white



> Weblink
40.001.147.00 / CHF
151.-
Chopping board, made of
wood

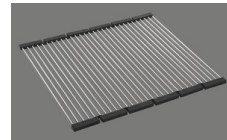

> Weblink
40.001.138.00 / CHF
125.-
Inox Pad

Compatible Articles



> Weblink
40.001.314.00 / CHF
155.-
Dispenser Nano



> Weblink
40.001.024.00 / CHF
427.-
Müllex Boxx 55/60-R Bio

Spares

You can find the compatible range of spares here [> Weblink](#)

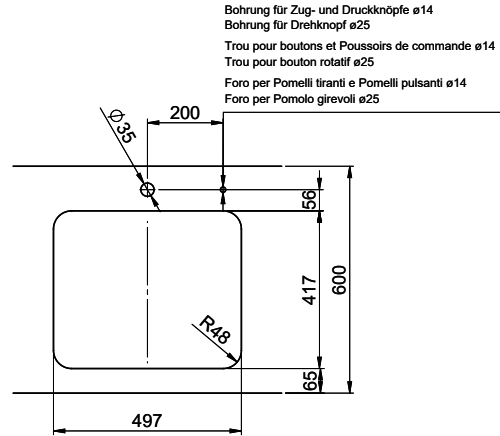
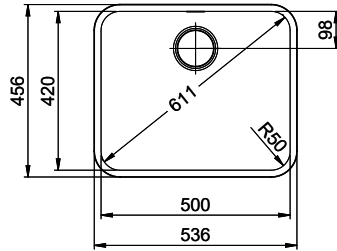

Bohrung für Zug- und Druckknöpfe ø14
 Bohrung für Drehknopf ø25
 Trou pour boutons et Poussoirs de commande ø14
 Trou pour bouton rotatif ø25
 Foro per Pomelli tiranti e Pomelli pulsanti ø14
 Foro per Pomolo girevoli ø25

Für dieses Dokument und den darin dargestellten Gegenstand bestehen wir uns als Rechte vor: Verwertbarkeit, Beherrschung an
 Gattung der Verwertung sowie Vorrecht einer Marken-Zuschreibung zu fordern. © Copyright 2020 Suter Inox AG. All rights reserved.

