

**BORA hob extractor PKA3AB All Black, Professional 3.0**
[> Web link](#)

**Article no.**  
40.002.232.00

**VRG**  
2.31  
**Price CHF**  
3006.- O excl. VAT

**Product description**
**Product description BORA Professional 3.0 hob extractor PKA3AB All Black**

Power control via control knob  
Power level display  
Electric shutter  
Shutter sensor  
Stainless steel grease filter  
Grease filter sensor  
Automatic hob extractor  
Automatic run-on  
Filter service indicator  
Interface for external devices  
Safety switch-off  
Connection option for two BORA universal fan modules  
All Black Version, DLC coated

**Technical data**

Supply voltage  
220 - 240 V  
Frequency  
50 Hz  
Maximum power consumption  
550 W  
Weight (incl. accessories and packaging)  
9.25 kg  
Dimensions (width x depth x height)  
482 x 540 x 176 mm  
Power levels  
1-9, P  
Exhaust air connection  
BORA Ecotube 245 x 89 mm

**Scope of delivery**

Hob extractor PKA3AB  
Operating and assembly instructions  
Height compensation plate set  
Mounting clamps  
Control knob All Black  
Stainless steel grease filter  
Filter tray  
Maintenance tray  
Closure flap  
Communication cable CAT 5  
Universal control unit  
Mains cable 1 m with plug type 12, 10 A  
Cable control knob - interface / fume cupboard  
Duct piece straight and duct piece bend

**Planning information**

Possible as recirculation or exhaust air system  
Can be combined with all BORA Professional hobs and BORA Universal fan modules  
Worktop height can be individually adjusted  
Worktop depth:  $\geq 700$  (in combination with the straight duct piece  $\geq 650$ )  
Air ducting possible to the right or left  
Fan can be placed in the plinth area due to low installation height (100 mm) (only when using the ULS plinth fan).  
Mounting type: flush-mounted or top-mounted  
Universal control unit as central connection point can be placed easily and space-saving in the plinth area.  
Connection between fume cupboard and universal control unit by means of a CAT 5 communication cable.  
The drawers or shelves in the base unit must be removable for maintenance and cleaning purposes.  
The BORA Ecotube duct system is optimally matched to the BORA hob fume cupboards and guarantees 100% function and best performance. In the case of an exhaust air path longer than 6m or high pressure losses, an additional universal fan module must be used.

## BORA hob extractor PKA3AB All Black, Professional 3.0

[> Web link](#)

**Planning note:** With these units, the duct connection is designed for the BORA Ecotube duct system. To connect BORA Ecotube (connection 245 x 89 mm) with Naber connections (222 x 89 mm), an adapter (EFA, 40.001.779.00) is available / can be ordered separately. Can be freely combined with all BORA universal fan modules (can be ordered separately, fan motor not included in PKA3AB scope of delivery).

### Accessory

#### Optional accessories



> Weblink  
40.002.034.00 / CHF  
135.-  
BORA socket USTJAB  
All Black

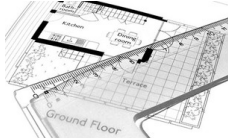

> Weblink  
80.100.016.00 / CHF  
359.-  
Ventilation planning



> Weblink  
80.100.017.00 / CHF  
192.-  
Revision of the planning

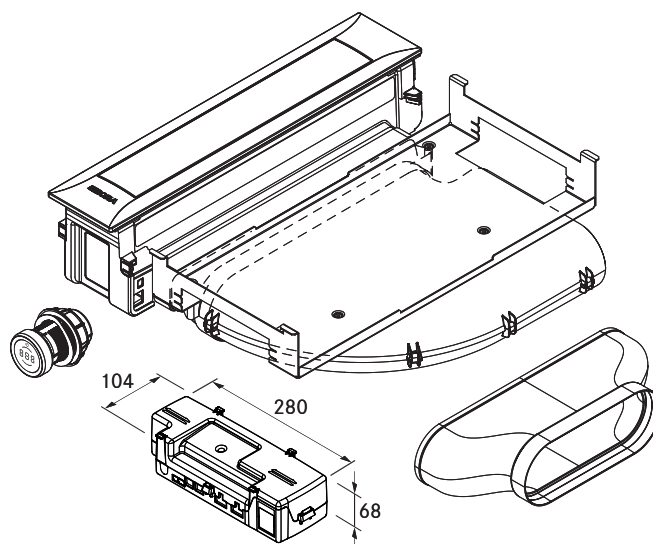
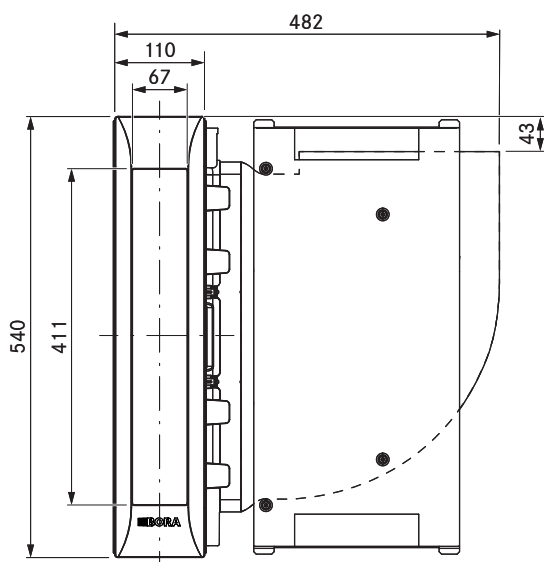
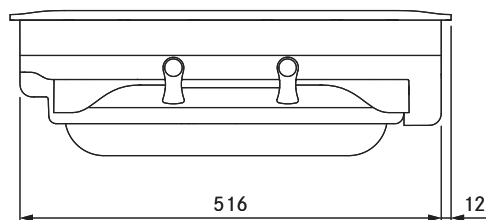
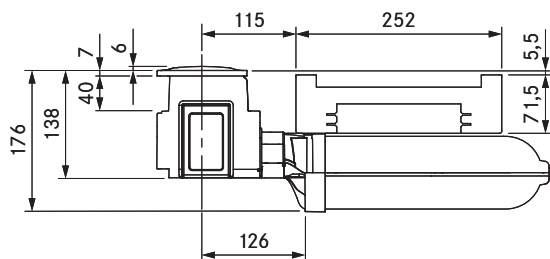

## technical data

Supply voltage	220 – 240 V
Frequency	50/60 Hz
Maximum power consumption	550 W
Power supply cable length	2 m
Dimensions (width x depth x height)	482 x 540 x 176 mm
Weight (incl. accessories/packaging)	9.25 kg
Cooktop extractor power levels	1 – 9, P
duct connection	BORA Ecotube

## Product description

- Intuitive control knob
- DLC (diamond-like-carbon) coated
- Automatic cover flap
- Premium design
- Minimum volume
- Simple cleaning
- Integrated grease drip pan
- Genuine stainless steel grease filter
- Modular system
- Automatic extractor control

## Scope of delivery

- Cooktop extractor PKA3AB with integrated 90° bend
- Straight duct element
- Control knob
- 4 x Pro knob ring All Black PKR3AB
- cover flap
- stainless steel grease filter
- Filter tray
- Maintenance tray
- CAT 5 communication cable
- Universal control unit
- connection cable for the control knob
- operating and installation instructions
- height adjustment plate set
- Mounting clamps
- Power supply cable with type E + F plugs
- Ecotube seal flat EFD

## Accessories

- PKA1FF stainless steel grease filter
- PKA1VKAB cover flap
- PKA1FW filter tray
- UNLI type I power supply cable (AUS)
- UNLJ type J power supply cable (CH)
- UNLG type G power supply cable (GB-IE)
- UNLB type B power supply cable (PH)
- UNLH type H power supply cable (IL)

## product- and planning instructions

- Suitable for use as a recirculation or exhaust system
- Compatible with all BORA Professional 3.0 cooktops and BORA Universal fan modules
- In addition, four knob ring All Black are included for the adjacent cooktops
- Use of an additional fan module is possible for very long or complex exhaust air channels
- The worktop height can be adjusted as necessary
- Worktop depth:  $\geq 700$  mm (in conjunction with the straight duct element  $\geq 650$  mm)
- Airflow possible to the right or left
- Fan can be positioned in the plinth area as a result of the low installation height (100 mm) (when using the ULS plinth fan only)
- Installation type: flush or surface-mounted
- Universal control unit as central connection point can be simply and compactly positioned in the plinth area
- The extractor and Universal control unit are connected by a CAT 5 communication cable
- The drawers and/or shelves in the floor unit must be removable for maintenance and cleaning purposes
- The BORA Ecotube duct system is optimally tailored to the BORA cooktop extractors and guarantees 100% functionality and optimum performance
- The Professional cooktop extractor system can be combined with all BORA sockets