

BORA Set PKA3 + ULS, Professional 3.0

[> Web link](#)

Article no.
40.002.288.00

VRG
5.56
Price CHF
3973.- O excl. VAT

Product description

BORA Professional 3.0 set offer consisting of PKA3 and ULS as well as other components as per scope of delivery

Scope of delivery of set offer «PKA3 and ULS»

1 hob extractor PKA3 (40.002.231.00)
1 ULS base fan (40.002.251.00)
1 Flat silencer USDF (40.002.248.00)
1 Ecotube bend 90° flat vertical EFBV90 (40.001.782.00)
1 Ecotube transition flat round straight EFRG (40.001.786.00)
1 Ecotube transition flat round offset EFRV110 (40.002.051.00)
1 Ecotube flat duct EFS375 (40.002.440.00)
2 Ecotube flat duct connectors EFV (40.001.788.00)
incl. gaskets

Planning note: With these units, the duct connection is designed for the BORA Ecotube duct system. To connect BORA Ecotube (connection 245 × 89 mm) with Naber connections (222 × 89 mm), an adapter (EFA, 40.001.779.00) is available / can be ordered separately.
Can be combined with all BORA Professional hobs (can be ordered separately, are not included in the set scope of delivery).

Accessory

Optional accessories



> Weblink
40.001.767.00 / CHF 97.-
BORA socket USTJ



> Weblink
40.002.034.00 / CHF 135.-
BORA socket USTJAB
All Black

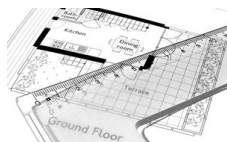

> Weblink
80.100.016.00 / CHF 359.-
Ventilation planning



> Weblink
80.100.017.00 / CHF 192.-
Revision of the planning

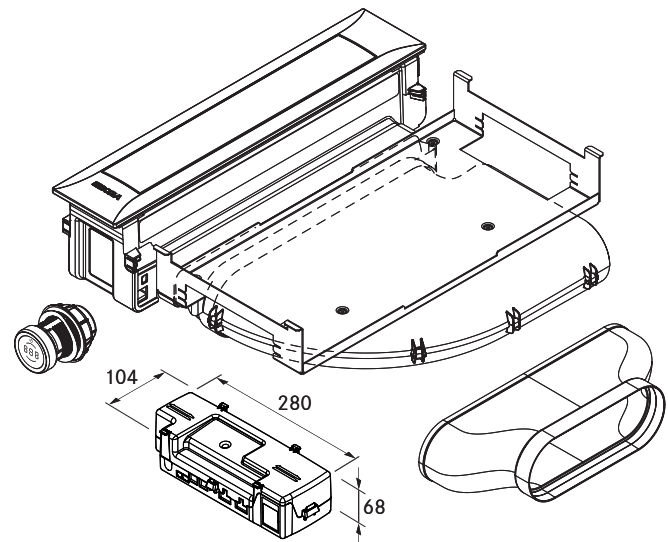
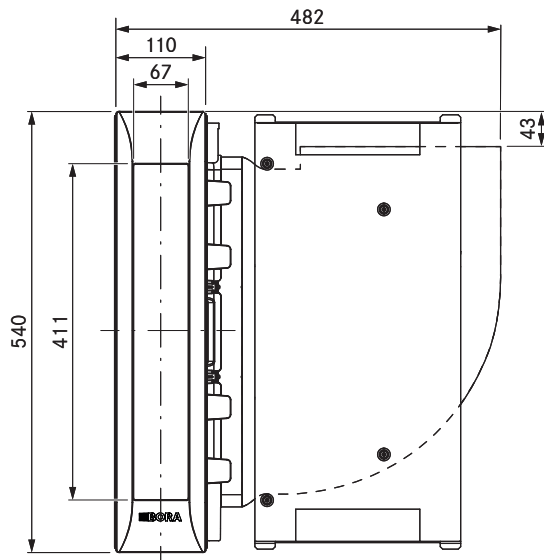
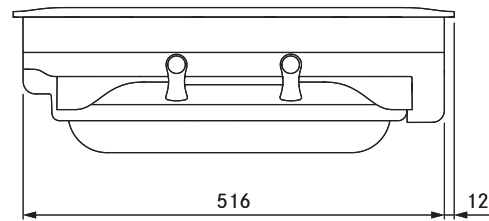
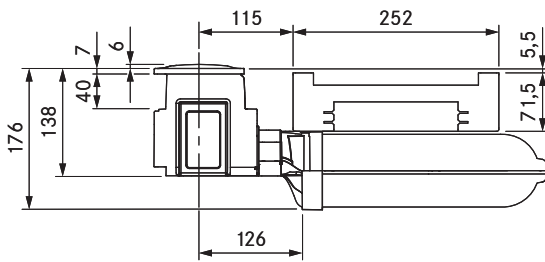

technical data

Supply voltage	220 – 240 V
Frequency	50/60 Hz
Maximum power consumption	550 W
Power supply cable length	2 m
Dimensions (width x depth x height)	482 x 540 x 176 mm
Weight (incl. accessories/packaging)	9.25 kg
Cooktop extractor power levels	1 – 9, P
duct connection	BORA Ecotube

Product description

- Intuitive control knob
- Automatic cover flap
- Premium design
- Minimum volume
- Simple cleaning
- Integrated grease drip pan
- Genuine stainless steel grease filter
- Modular system
- Automatic extractor control
- Demo mode

Scope of delivery

- Cooktop extractor PKA3 with integrated 90° bend
- Straight duct element
- Control knob
- cover flap
- stainless steel grease filter
- Filter tray
- Maintenance tray
- CAT 5 communication cable
- Universal control unit
- connection cable for the control knob
- operating and installation instructions
- height adjustment plate set
- Mounting clamps
- Power supply cable with type E + F plugs
- Ecotube seal flat EFD

Accessories

- PKA1FF stainless steel grease filter
- PKA1VK cover flap
- PKA1FW filter tray
- UNLI type I power supply cable (AUS)
- UNLJ type J power supply cable (CH)
- UNLG type G power supply cable (GB-IE)
- UNLB type B power supply cable (PH)
- UNLH type H power supply cable (IL)

product- and planning instructions

- Suitable for use as a recirculation or exhaust system
- Compatible with all BORA Professional 3.0 cooktops and BORA Universal fan modules
- Use of an additional fan module is possible for very long or complex exhaust air channels
- The worktop height can be adjusted as necessary
- Worktop depth: ≥ 700 mm (in conjunction with the straight duct element ≥ 650 mm)
- Airflow possible to the right or left
- Fan can be positioned in the plinth area as a result of the low installation height (100 mm) (when using the ULS plinth fan only)
- Installation type: flush or surface-mounted
- Universal control unit as central connection point can be simply and compactly positioned in the plinth area
- The extractor and Universal control unit are connected by a CAT 5 communication cable
- The drawers and/or shelves in the floor unit must be removable for maintenance and cleaning purposes
- The BORA Ecotube duct system is optimally tailored to the BORA cooktop extractors and guarantees 100% functionality and optimum performance
- The Professional cooktop extractor system can be combined with all BORA sockets