

## EFBV90, BORA Ecotube shallow, vertical 90° bend

[> Web link](#)

**Article no.**  
40.001.782.00

**Price CHF**  
47.- D excl. VAT

## Product description

**EFBV90 BORA Ecotube bend 90° flat vertical incl. sealing material**

## Technical data

**Dimensions (W x D x H)**

255 x 139 x 139 mm

**Material characteristics**

V0 according to UL94

B1 according to DIN 4102-1

**Number of required seals\***

2 x EFD

**Weight**

0,35 kg

\* Gaskets are included in the price and delivery.

**Accessory (ordered separately)**

EFMS mounting bracket set

**Planning tips**

Moulded part with two shallow sleeve forms

For use with units with a BORA Ecotube duct connection (245 x 89 mm). To connect BORA Ecotube to Naber fittings (222 x 89 mm), an adapter (EFA, 40.001.779) is available / to be ordered separately.

# EFBH90

BORA Ecotube Bogen 90° flach horizontal

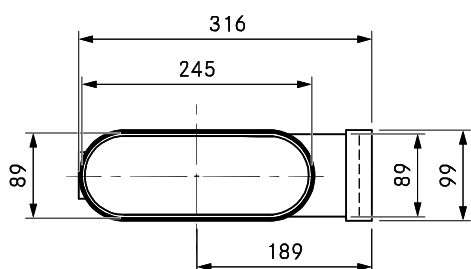
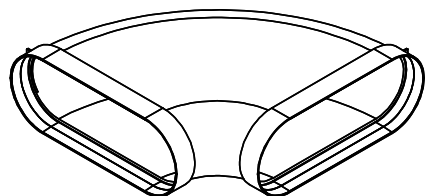

## Technische Daten

Abmessungen (BxTxH)	316 x 316 x 99 mm
Materialeigenschaft	V0 nach UL94, B1 nach DIN 4102-1
Anzahl notwendiger Dichtungen	2 x EFD
Gewicht	0,75 kg

## Zubehör

- Montagebügel Set EFMS

## Planungshinweise

- Formteil mit zwei Muffenausbildungen flach

# EFBV90

BORA Ecotube Bogen 90° flach vertikal

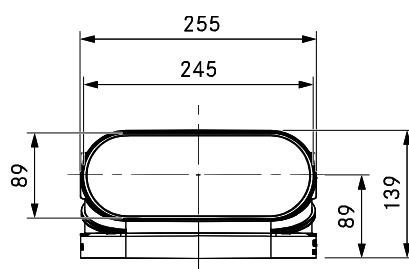
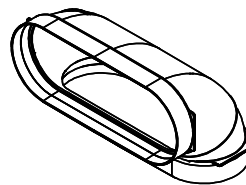

## Technische Daten

Abmessungen (BxTxH)	255 x 139 x 139 mm
Materialeigenschaft	V0 nach UL94, B1 nach DIN 4102-1
Anzahl notwendiger Dichtungen	2 x EFD
Gewicht	0,35 kg

## Zubehör

- Montagebügel Set EFMS

## Planungshinweise

- Formteil mit zwei Muffenausbildungen flach