

**BORA air cleaning box flexible ULBF (successor ULB1)**[> Web link](#)

**Article no.**  
40.002.159.00

**Price CHF**  
270.- O excl. VAT

**Product description****Technical data****Mass activated carbon incl. carrier material**

approx. 1,9 kg

**Filter material**

Activated carbon based on coconut shells

**Material housing**

Plastic

**Dimensions (width x depth x height)**

329 x 441 x 98 mm

**Weight**

approx. 2,5 kg

**Connection BORA Ecotube**

245 x 89 mm

**Weight**

Approx. 2,5 kg

**Service life**

Approx. 1,5 years

**Connection**

BORA Ecotube 245 x 89 mm

**Product description**

Fitting with socket formation flat

Effective odour elimination

Flexible component

Complete system

Connection to BORA Ecotube 245 x 89 mm

Possibility for hanging or horizontal mounting

Allow for the possibility of revision

Allow a backflow opening of at least 500 cm<sup>2</sup> (e.g. recessed plinth or lamella plinth)

Distance to adjacent components approx. 50 mm

**Scope of delivery**

ULBF

Operating and mounting instructions

1 filter suspension

1 sealing tape UDB1

1 EF47

1 EFA

2 EFD

**Planning information**

With the air purification box ULBF the connection is designed for BORA Ecotube (245 x 89mm). To connect BORA Ecotube with hub connections (222 x 89 mm), an EFA adapter, which is automatically included in the delivery.

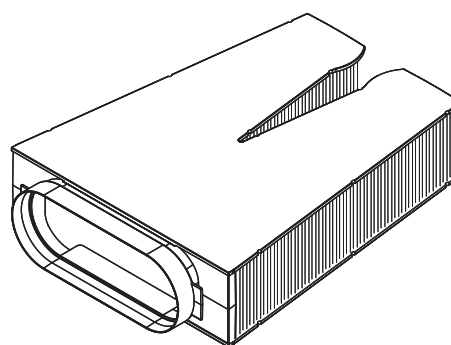
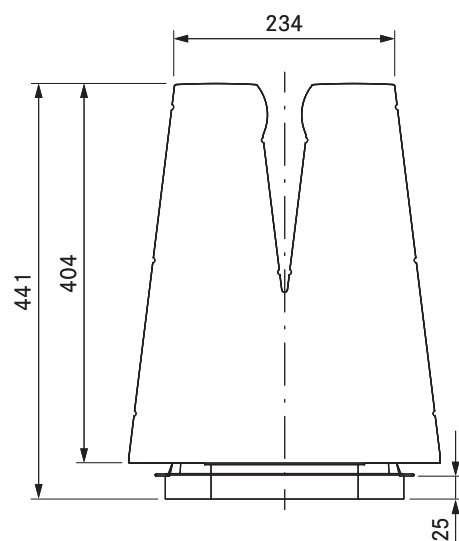
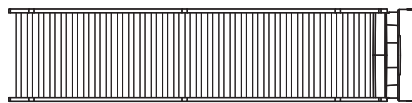
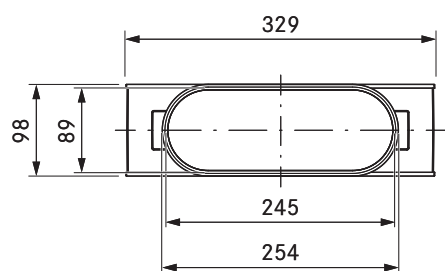

## technical data

Dimensions (WxDxH)	329 x 441 x 98 mm
Weight (incl. accessories/packaging)	Approx. 2,5 kg
Casing material	Plastic
duct connection	BORA Ecotube
Filter material	Activated charcoal made from coconut shells
Activated charcoal granulate volume	1.9 kg
Maximum filter service life	300 h (1,5 years)

## Product description

- Service life approx. 300 h/1.5 years
- effective odour removal
- Flexible component
- Including required Ecotube seals
- complete system

## Scope of delivery

- Flexible air cleaning box ULBF
- 1x filter mounting bracket
- 1 x EFD
- 1 x EF47
- installation instructions

## product- and planning instructions

- Clearance of at least 4 cm is required to replace the recirculation unit
- Suspended and horizontal installation options
- Moulded part with a shallow sleeve form
- Access for maintenance must be considered during planning
- Ensure minimum return flow aperture of 500 cm<sup>2</sup> (e.g. shortened plinth plate or slatted plinth)