

Comfort COM 34

> Weblink



**Montaggio**  
Lavelli da incasso  
**Modello**  
COM 34  
**Materiale**  
Acciaio inox 18/10  
**N. di articolo**  
10.102.726.00

**Dimensioni base**  
40 cm  
**Piletta**  
3½" Salvaspazio  
**Finitura**  
Lucido  
**Prezzo in CHF**  
871.- IVA esclusa

**Dimensioni lavello**  
340x420x175mm  
**Raggi d'angolo**  
50 mm

Tecnologia di scarico e troppopieno



Griglietta - tipo S



Troppopieno coperto

Premontaggio della piletta

Montaggio della piletta in fabbrica

Distributore - opzioni di montaggio

Posizione a scelta

Tecnologia di scarico e troppopieno

Pomolo inclusi



Prime

Prezzi (aggiornati al 05.05.26 / IVA esclusa)

Modello	Materiale	Piletta	N. di articolo	Prezzo in CHF	
Comfort COM 34	Acciaio inox 18/10, Lucido	3½" Tipo	10.103.102.00	830.-	> Weblink
		3½" Salvaspazio	10.102.726.00	871.-	> Weblink

Accessorio

Accessori opzionali



> Weblink  
40.001.004.00 / CHF 42.-  
Vaschetta, forato



> Weblink  
40.000.971.00 / CHF 106.-  
Vaschetta, forato

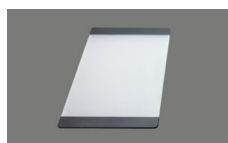

> Weblink  
40.000.915.00 / CHF 151.-  
Tagliere, in vetro, bianco

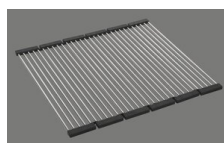

> Weblink  
40.001.138.00 / CHF 125.-  
Inox Pad

Prodotti compatibili



> Weblink  
40.001.314.00 / CHF 155.-  
Distributore Nano



> Weblink  
40.001.023.00 / CHF 347.-  
Müllex Boxx 40-R

Ricambi

Qui trovate tutti gli accessori compatibili > Weblink

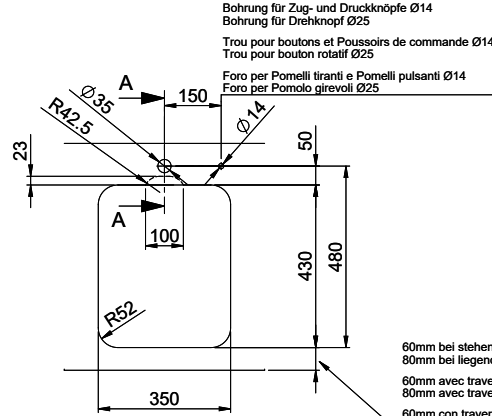
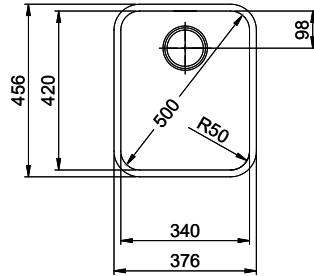

**A-A**  
**MAßSTAB 1 : 2**

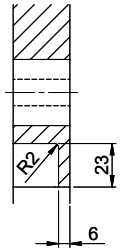

Bohrung für Zug- und Druckknöpfe Ø14  
 Bohrung für Drehknopf Ø25  
 Trou pour boutons et Pousoirs de commande Ø14  
 Trou pour bouton rotatif Ø25  
 Foro per Pomelli tiranti e Pomelli pulsanti Ø14  
 Foro per Pomolo girevoli Ø25

60mm bei stehender Traverse  
 80mm bei liegender Traverse  
 60mm avec traverse allongé  
 80mm avec traverse debout  
 60mm con traversa coricata  
 80mm con traversa stante

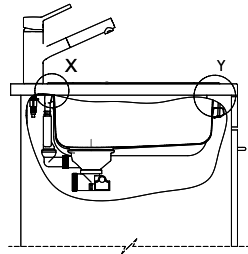
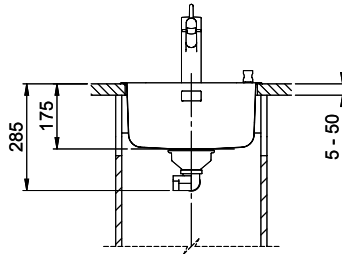

**DETAIL X**  
**MAßSTAB 1 : 2**

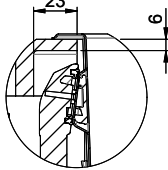

**DETAIL Y**  
**MAßSTAB 1 : 2**

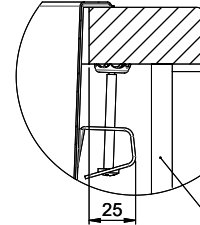

**Achtung: Traverse vorne beachten!**  
**Attention: respecter la traverse avant!**  
**Attenzione: rispettare la traversa avanti!**

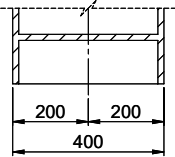
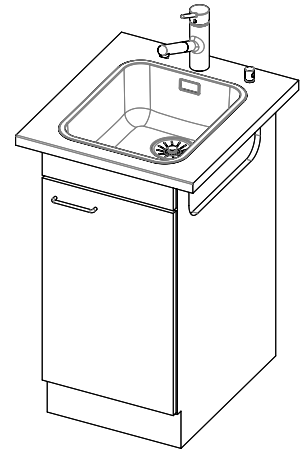

Für diese Dokument sind den zugewiesenen Dokumenten beiliegen wie eine alle Rechte vorbehalten. Verwendungs-Belegungen an  
 Einzelne Verwendung ohne vorherige schriftliche Zustimmung der Hersteller. © Copyright 2020 Suter Inox AG. Alle Rechte vorbehalten.